

Medical furniture made of powder-coated steel

Furniture construction made of double zinc plated varnished sheet, powder-coated with silver ions active ingredients - natural antibacterial agent IGP-DURA®care. Front & body made in double-walled system with moisture resistant, stiffening & noise-damping insulation, ensuring no empty metallic sound while opening & closing doors and drawers.

Smooth internal walls of high cabinets and cabinets are structurally equipped with specialized rails (rasters) enabling easy adjustment of the height of the position of the inside mounted components such as shelves, baskets and cuvettes. Shelves made of powder-coated galvanized steel with step height adjustable on L-shaped brackets made of aluminum alloy.

30mm thick worktops, described in detail in the additional equipments section, are available in two variants:

- stainless-steel with stiffening & noise-damping insulation;
- made of composite material with non-porous surface, with an anti-bruise groove.



OPEN TYPE SUSPENDED CABINETRY

REF: KL104 103

Single-compartment cabinetry
2 x adjustable shelf

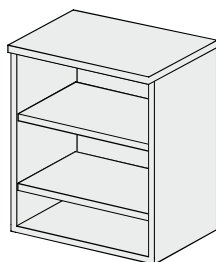

Dimensions (mm)*		
W	D	H
400x300x720mm		
500x300x720mm		
600x300x720mm		

OPEN TYPE SUSPENDED CABINETRY

REF: KL104 103

Single-compartment cabinetry
2 x adjustable shelf

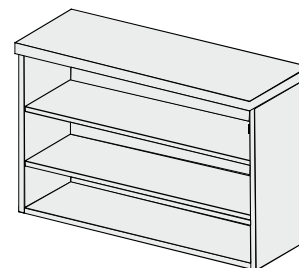

Dimensions (mm)*		
W	D	H
800x300x720mm		
900x300x720mm		
1000x300x720mm		

SINGLE-DOOR GLAZED SUSPENDED CABINETRY

REF: KL104 102

Single-compartment cabinetry
1 x glazed door
2 x adjustable shelf

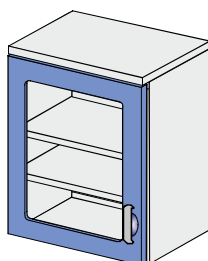

Dimensions (mm)*		
W	D	H
400x300x720mm		
500x300x720mm		
600x300x720mm		

DOUBLE-DOOR GLAZED SUSPENDED CABINETRY

REF: KL104 101

Single-compartment cabinetry
2 x glazed door
2 x adjustable shelf

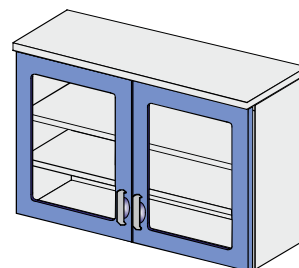

Dimensions (mm)*		
W	D	H
800x300x720mm		
900x300x720mm		
1000x300x720mm		

SINGLE-DOOR SUSPENDED CABINETRY

REF: KL104 202

Single-compartment cabinetry
1 x full door
2 x adjustable shelf

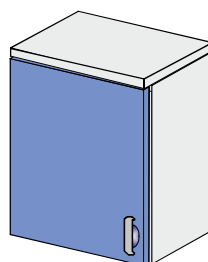

Dimensions (mm)*		
W	D	H
400x300x720mm		
500x300x720mm		
600x300x720mm		

DOUBLE-DOOR SUSPENDED CABINETRY

REF: KL104 201

Single-compartment cabinetry
2 x full door
2 x adjustable shelf

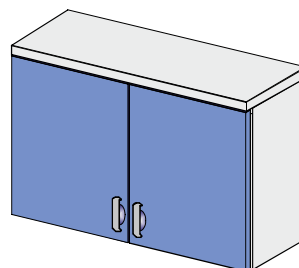

Dimensions (mm)*		
W	D	H
800x300x720mm		
900x300x720mm		
1000x300x720mm		



OPEN TYPE CABINET

REF: KL103 105

Single-compartment cabinet
1 x adjustable shelf
Worktop made of stainless-steel grade
0H18N9 with noise-damping insulation.

Dimensions (mm)*		
W	D	H
400x600x900mm		
500x600x900mm		
600x600x900mm		

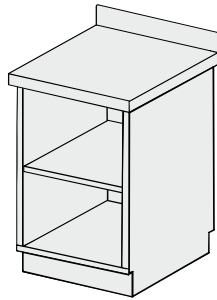

SINGLE-DOOR CABINET

REF: KL103 101

Single-compartment cabinet
1 x full door
1 x adjustable shelf
Worktop made of stainless-steel grade
0H18N9 with noise-damping insulation.

Dimensions (mm)*		
W	D	H
400x600x900mm		
500x600x900mm		
600x600x900mm		

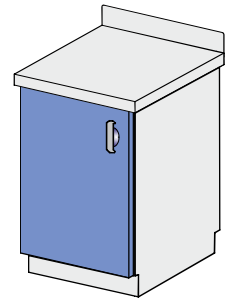

SINGLE-DOOR CABINET with drawer

REF: KL103 102

Single-compartment cabinet
1 x fully-extendible drawer
1 x full door
1 x adjustable shelf
Worktop made of stainless-steel grade
0H18N9 with noise-damping insulation.

Dimensions (mm)*		
W	D	H
400x600x900mm		
500x600x900mm		
600x600x900mm		

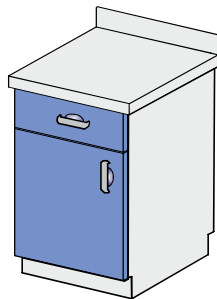

TWO-CARGO DRAWERS CABINET

REF: KL103 108

Single-compartment cabinet
2 x CARGO drawer
Worktop made of stainless-steel grade
0H18N9 with noise-damping insulation.

Dimensions (mm)*		
W	D	H
600x600x900mm		
800x600x900mm		
900x600x900mm		

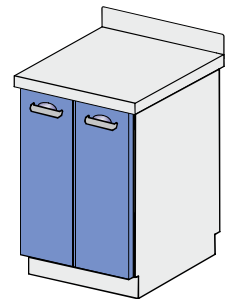

TWO DRAWERS CABINET

REF: KL103 109

Single-compartment cabinet
2 x fully-extendible drawer
Worktop made of stainless-steel grade
0H18N9 with noise-damping insulation.

Dimensions (mm)*		
W	D	H
400x600x900mm		
500x600x900mm		
600x600x900mm		

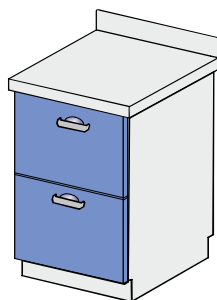

THREE DRAWERS CABINET

REF: KL103 103

Single-compartment cabinet
3 x fully-extendible drawer
Worktop made of stainless-steel grade
0H18N9 with noise-damping insulation.

Dimensions (mm)*		
W	D	H
400x600x900mm		
500x600x900mm		
600x600x900mm		

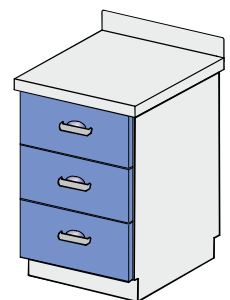

FOUR DRAWERS CABINET

REF: KL103 104

Single-compartment cabinet
4 x fully-extendible drawer
Worktop made of stainless-steel grade
0H18N9 with noise-damping insulation.

Dimensions (mm)*		
W	D	H
400x600x900mm		
500x600x900mm		
600x600x900mm		

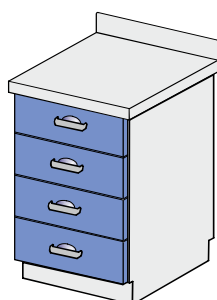

FIVE DRAWERS CABINET

REF: KL103 107

Single-compartment cabinet
5 x fully-extendible drawer
Worktop made of stainless-steel grade
0H18N9 with noise-damping insulation.

Dimensions (mm)*		
W	D	H
400x600x900mm		
500x600x900mm		
600x600x900mm		

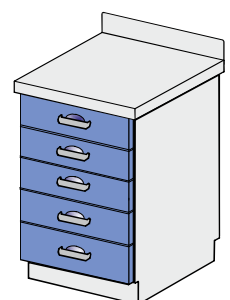

DOUBLE-DOOR CABINET

REF: KL103 201

Single-compartment cabinet
2 x full door
1 x adjustable shelf
Worktop made of stainless-steel grade
0H18N9 with noise-damping insulation.

Dimensions (mm)*		
W	D	H
800x600x900mm		
900x600x900mm		
1000x600x900mm		

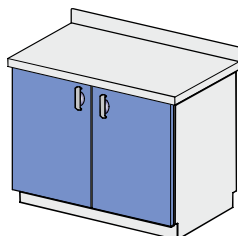

SLIDING-DOORS CABINET

REF: KL103 205

Single-compartment cabinet
2 x full sliding-door
1 x adjustable shelf
Worktop made of stainless-steel grade
0H18N9 with noise-damping insulation.

Dimensions (mm)*		
W	D	H
800x600x900mm		
900x600x900mm		
1000x600x900mm		

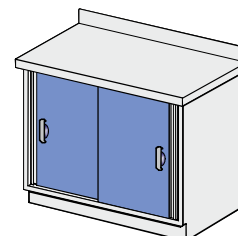

DOUBLE-DOOR CABINET with drawer

REF: KL103 206

Single-compartment cabinet
1 x fully-extendible drawer
2 x full door
1 x adjustable shelf
Worktop made of stainless-steel grade
0H18N9 with noise-damping insulation.

Dimensions (mm)*		
W	D	H
800x600x900mm		
900x600x900mm		
1000x600x900mm		

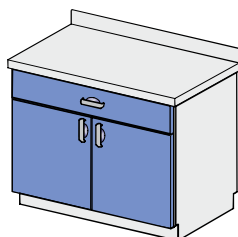

DOUBLE-DOOR CABINET with 2 drawers

REF: KL103 202

Single-compartment cabinet
2 x fully-extendible drawer
2 x full door
1 x adjustable shelf
Worktop made of stainless-steel grade
0H18N9 with noise-damping insulation.

Dimensions (mm)*		
W	D	H
800x600x900mm		
900x600x900mm		
1000x600x900mm		

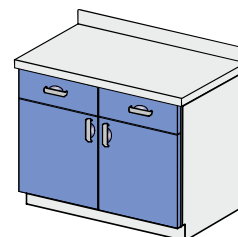

DOUBLE-DOOR CABINET with 3 drawers

REF: KL103 203

Double-compartment cabinet
3 x fully-extendible drawer
1 x full door
1 x adjustable shelf
Worktop made of stainless-steel grade
0H18N9 with noise-damping insulation.

Dimensions (mm)*		
W	D	H
800x600x900mm		
900x600x900mm		
1000x600x900mm		

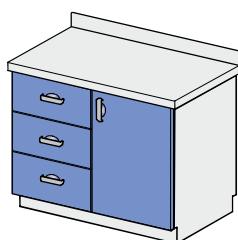

DOUBLE-DOOR CABINET with 4 drawers

REF: KL103 204

Double-compartment cabinet
4 x fully-extendible drawer
1 x full door
1 x adjustable shelf
Worktop made of stainless-steel grade
0H18N9 with noise-damping insulation.

Dimensions (mm)*		
W	D	H
800x600x900mm		
900x600x900mm		
1000x600x900mm		

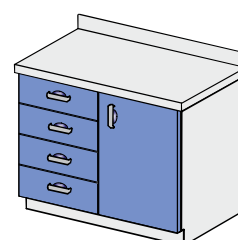

DOUBLE-DOOR CABINET with 5 drawers

REF: KL103 207

Double-compartment cabinet
5 x fully-extendible drawer
1 x full door
1 x adjustable shelf
Worktop made of stainless-steel grade
0H18N9 with noise-damping insulation.

Dimensions (mm)*		
W	D	H
800x600x900mm		
900x600x900mm		
1000x600x900mm		

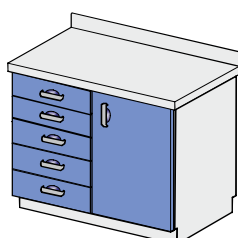

DOUBLE-DOOR CABINET with 5 drawers

REF: KL103 208

Double-compartment cabinet
5 x fully-extendible drawer
1 x full door
Worktop made of stainless-steel grade
0H18N9 with noise-damping insulation.

Dimensions (mm)*		
W	D	H
800x600x900mm		
900x600x900mm		
1000x600x900mm		

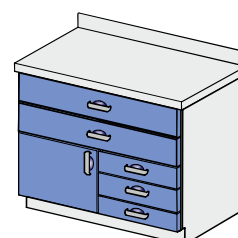

SINGLE-DOOR CABINET

REF: KL105 101

Single-compartment high cabinet
1 x full door
5 x adjustable shelf

Dimensions (mm)*		
W	D	H
400x600x2100mm		
500x600x2100mm		
600x600x2100mm		

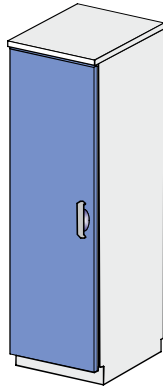

DOUBLE-DOOR CABINET

REF: KL105 201

Double-compartment high cabinet
2 x full door
4 x adjustable shelf

Dimensions (mm)*		
W	D	H
400x600x2100mm		
500x600x2100mm		
600x600x2100mm		

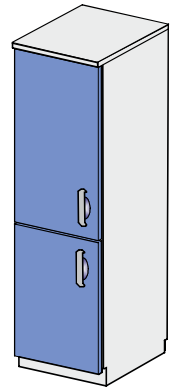

SINGLE-DOOR GLAZED CABINET

REF: KL105 102

Single-compartment high cabinet
1 x glazed door
5 x adjustable shelf

Dimensions (mm)*		
W	D	H
400x600x2100mm		
500x600x2100mm		
600x600x2100mm		

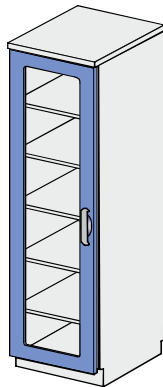

SINGLE-DOOR GLAZED CABINET

REF: KL105 103

Single-compartment high cabinet
1 x glazed door
5 x adjustable shelf

Dimensions (mm)*		
W	D	H
400x600x2100mm		
500x600x2100mm		
600x600x2100mm		

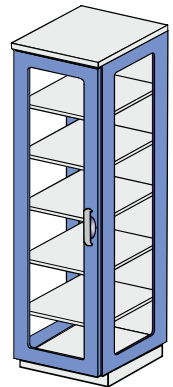

DOUBLE-DOOR GLAZED CABINET

REF: KL105 202

Double-compartment high cabinet
1 x glazed door
1 x full door
4 x adjustable shelf

Dimensions (mm)*		
W	D	H
400x600x2100mm		
500x600x2100mm		
600x600x2100mm		

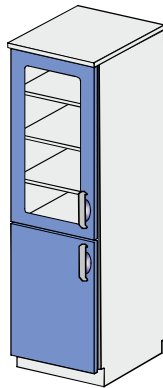

DOUBLE-DOOR GLAZED CABINET

REF: KL105 203

Double-compartment high cabinet
1 x glazed door
1 x full door
4 x adjustable shelf

Dimensions (mm)*		
W	D	H
400x600x2100mm		
500x600x2100mm		
600x600x2100mm		

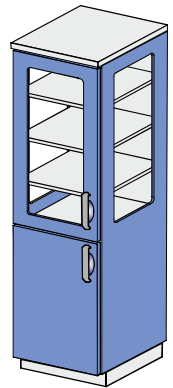

PASS-THROUGH CABINET

REF: KL105 111

Single-compartment high cabinet
2 x full opposite door
5 x adjustable shelf

Dimensions (mm)*		
W	D	H
400x600x2100mm		
500x600x2100mm		
600x600x2100mm		

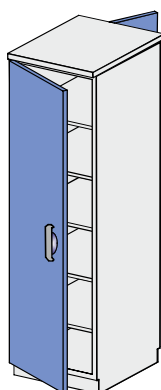

PASS-THROUGH GLAZED CABINET

REF: KL105 213

Single-compartment high cabinet
2 x glazed opposite door
5 x adjustable shelf

Dimensions (mm)*		
W	D	H
400x600x2100mm		
500x600x2100mm		
600x600x2100mm		

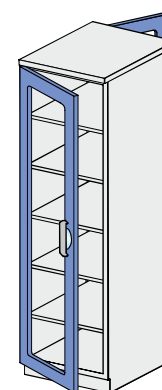

WARDROBE

REF: KL105 104

Single-compartment high cabinet
1 x full door
2 x adjustable shelf
1 x rod for clothes hangers

Dimensions (mm)*		
W	D	H
400x600x2100mm		
500x600x2100mm		
600x600x2100mm		

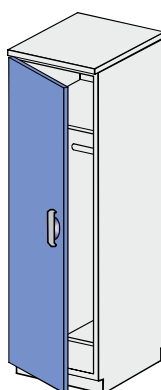

PASS-THROUGH WARDROBE

REF: KL105 112

Single-compartment high cabinet
2 x full opposite door
2 x adjustable shelf
1 x rod for clothes hangers

Dimensions (mm)*		
W	D	H
400x600x2100mm		
500x600x2100mm		
600x600x2100mm		

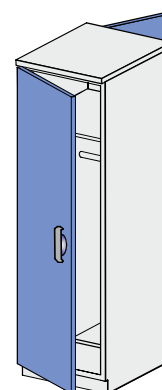

LOCKABLE DEPOSIT CABINET

REF: KL105 106

Four-compartment high cabinet
4 x lockable full door

Dimensions (mm)*		
W	D	H
400x600x2100mm		
500x600x2100mm		
600x600x2100mm		

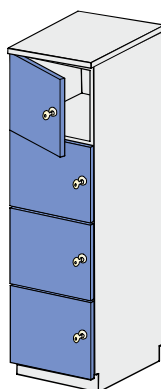

LOCKABLE PASS-THROUGH DEPOSIT CABINET

REF: KL105 109

Five-compartment high cabinet
10 x lockable full opposite door

Dimensions (mm)*		
W	D	H
400x600x2100mm		
500x600x2100mm		
600x600x2100mm		

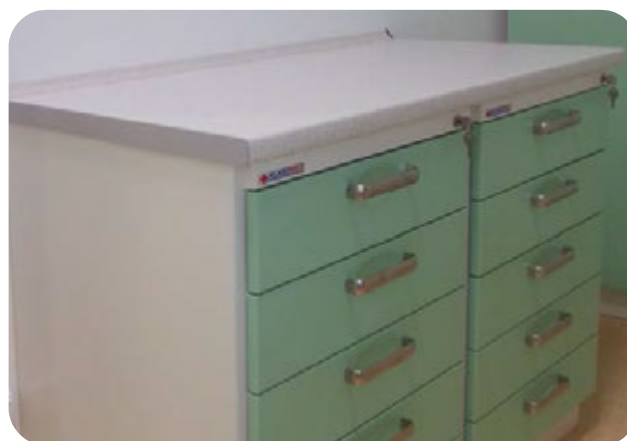
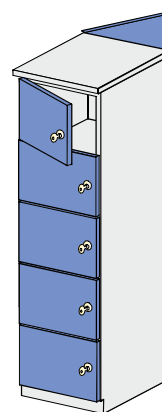

SINGLE-DOOR CABINET for catheters

REF: KL105 108

Single-compartment high cabinet
1 x full door
3 x retractable hanger for catheters
2 x adjustable shelf

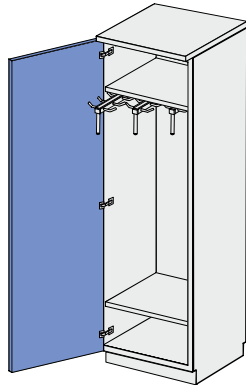

Dimensions (mm)*		
W	D	H
500x600x2100mm		
600x600x2100mm		

LOCKABLE DEPOSIT CABINET

REF: KL105 116

Eight-compartment high cabinet
8 x lockable full door

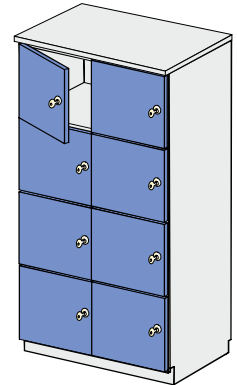

Dimensions (mm)*		
W	D	H
800x600x2100mm		
900x600x2100mm		
1000x600x2100mm		

GLAZED CABINET for endoscopes

REF: KL105 107

Single-compartment high cabinet
1 x glazed door
2 x retractable hanger for endoscope
1 x drip tray
1 x container for endoscope accessories

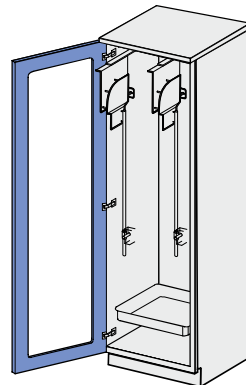

Dimensions (mm)*		
W	D	H
500x600x2100mm		
600x600x2100mm		

GLAZED CABINET for endoscopes

REF: KL105 304

Single-compartment high cabinet
2 x glazed door
4 x retractable hanger for endoscope
1 x drip tray
1 x container for endoscope accessories

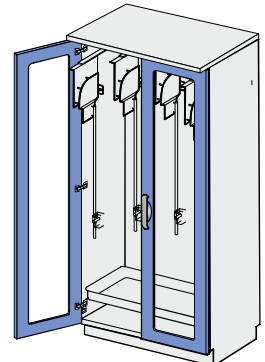

Dimensions (mm)*		
W	D	H
1000x600x2100mm		
1100x600x2100mm		
1200x600x2100mm		

WARDROBE

REF: KL105 105

Double-compartment high cabinet
2 x full door
4 x adjustable shelf
2 x rod for clothes hangers

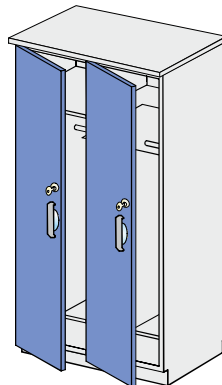

Dimensions (mm)*		
W	D	H
800x600x2100mm		
900x600x2100mm		
1000x600x2100mm		

PASS-THROUGH WARDROBE

REF: KL105 312

Double-compartment high cabinet
4 x full opposite door
4 x adjustable shelf
2 x rod for clothes hangers

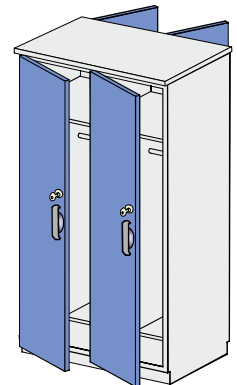

Dimensions (mm)*		
W	D	H
800x600x2100mm		
900x600x2100mm		
1000x600x2100mm		



DOUBLE-DOOR CABINET

REF: KL105 301

Single-compartment high cabinet
2 x full door
5 x adjustable shelf

Dimensions (mm)*		
W	D	H
800x600x2100mm		
900x600x2100mm		
1000x600x2100mm		

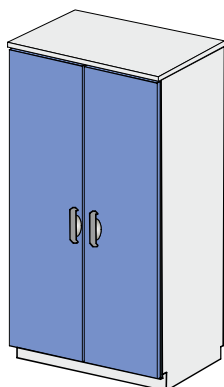

PASS-THROUGH CABINET

REF: KL105 315

Single-compartment high cabinet
4 x full opposite door
5 x adjustable shelf

Dimensions (mm)*		
W	D	H
800x600x2100mm		
900x600x2100mm		
1000x600x2100mm		

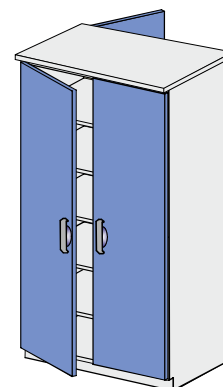

SLIDING-DOORS WARDROBE

REF: KL105 311

Single-compartment high cabinet
2 x full sliding-door
2 x adjustable shelf

Dimensions (mm)*		
W	D	H
800x600x2100mm		
900x600x2100mm		
1000x600x2100mm		

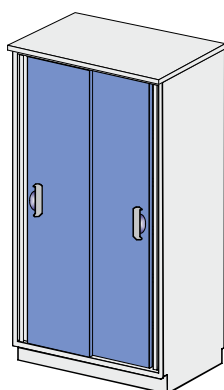

SLIDING-DOORS CABINET

REF: KL105 501

Single-compartment high cabinet
2 x full sliding-door
5 x adjustable shelf

Dimensions (mm)*		
W	D	H
800x600x2100mm		
900x600x2100mm		
1000x600x2100mm		

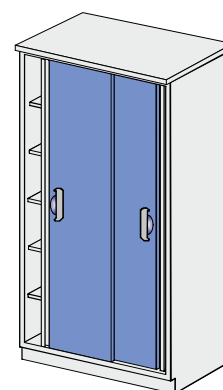

DOUBLE-DOOR GLAZED CABINET

REF: KL105 302

Single-compartment high cabinet
2 x glazed door
5 x adjustable shelf

Dimensions (mm)*		
W	D	H
800x600x2100mm		
900x600x2100mm		
1000x600x2100mm		

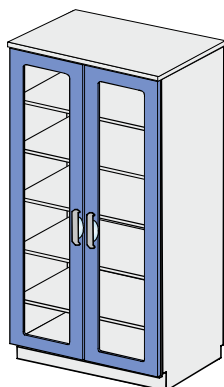

DOUBLE-DOOR GLAZED CABINET

REF: KL105 303

Single-compartment high cabinet
2 x glazed door
5 x adjustable shelf

Dimensions (mm)*		
W	D	H
800x600x2100mm		
900x600x2100mm		
1000x600x2100mm		

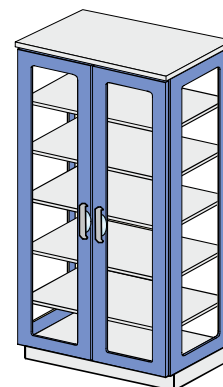

FOUR-DOORS CABINET REF: KL105 401

Double-compartment high cabinet
4 x full door
4 x adjustable shelf

Dimensions (mm)*		
W	D	H
800x600x2100mm		
900x600x2100mm		
1000x600x2100mm		

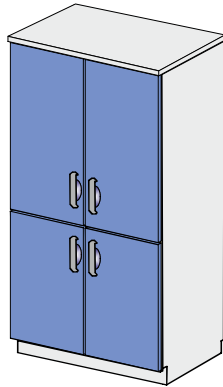

FOUR SLIDING-DOORS HIGH CABINET REF: KL105 601

Double-compartment high cabinet
4 x full sliding-door
4 x adjustable shelf

Dimensions (mm)*		
W	D	H
800x600x2100mm		
900x600x2100mm		
1000x600x2100mm		

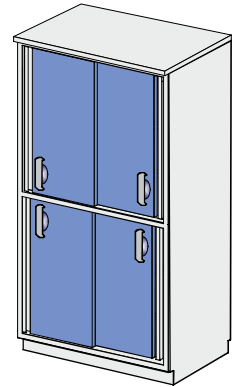

FOUR-DOORS GLAZED CABINET REF: KL105 402

Double-compartment high cabinet
2 x full door
2 x glazed door
4 x adjustable shelf

Dimensions (mm)*		
W	D	H
800x600x2100mm		
900x600x2100mm		
1000x600x2100mm		

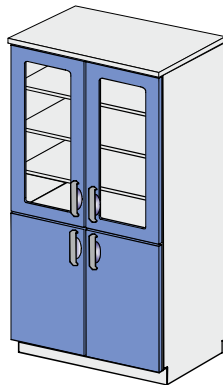

FOUR-DOORS GLAZED CABINET REF: KL105 403

Double-compartment high cabinet
2 x full door
2 x glazed door
4 x adjustable shelf

Dimensions (mm)*		
W	D	H
800x600x2100mm		
900x600x2100mm		
1000x600x2100mm		

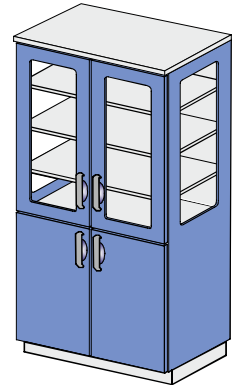

FOUR SLIDING-DOORS GLAZED CABINET REF: KL105 602

Double-compartment high cabinet
2 x full door
2 x glazed, sliding-door
4 x adjustable shelf

Dimensions (mm)*		
W	D	H
800x600x2100mm		
900x600x2100mm		
1000x600x2100mm		

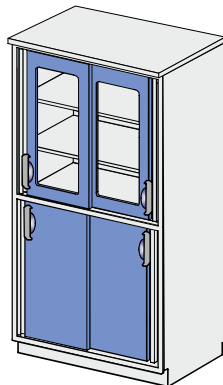

FOUR SLIDING-DOORS GLAZED CABINET REF: KL105 603

Double-compartment high cabinet
2 x full door
2 x glazed, sliding-door
4 x adjustable shelf

Dimensions (mm)*		
W	D	H
800x600x2100mm		
900x600x2100mm		
1000x600x2100mm		

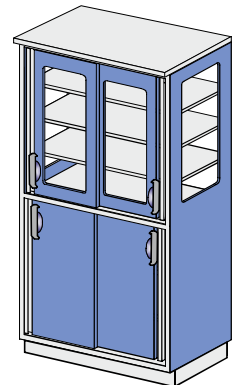

DOUBLE-DOOR GLAZED CABINET

REF: KL105 502

Single-compartment high cabinet
2 x glazed, sliding-door
5 x adjustable shelf

Dimensions (mm)*		
W	D	H
800x600x2100mm		
900x600x2100mm		
1000x600x2100mm		

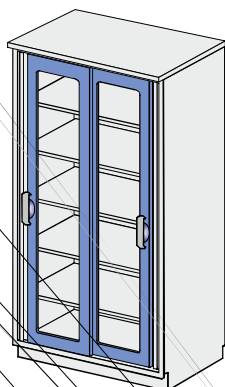

DOUBLE-DOOR GLAZED CABINET

REF: KL105 503

Single-compartment high cabinet
2 x glazed, sliding-door
5 x adjustable shelf

Dimensions (mm)*		
W	D	H
800x600x2100mm		
900x600x2100mm		
1000x600x2100mm		

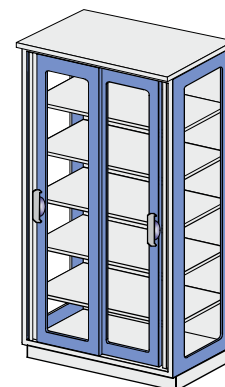

PASS-THROUGH FOUR-DOORS CABINET

REF: KL105 512

Single-compartment high cabinet
4 x glazed, opposite-door
5 x adjustable shelf

Dimensions (mm)*		
W	D	H
800x600x2100mm		
900x600x2100mm		
1000x600x2100mm		

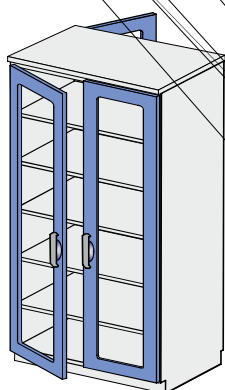

FOUR-DOORS GLAZED CABINET

REF: KL105 604

Double-compartment high cabinet
4 x glazed, sliding-door
5 x adjustable shelf

Dimensions (mm)*		
W	D	H
800x600x2100mm		
900x600x2100mm		
1000x600x2100mm		

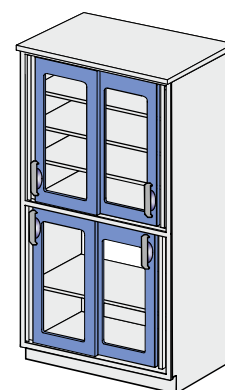

DOUBLE-DOOR CABINET with 2 drawers

REF: KL105 404

Double-compartment cabinet
2 x CARGO drawer
2 x full door
1 x adjustable shelf

Dimensions (mm)*		
W	D	H
800x600x2100mm		
900x600x2100mm		
1000x600x2100mm		

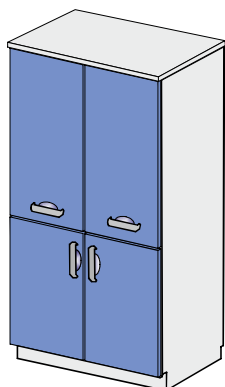

DOUBLE-DOOR CABINET with 3 drawers

REF: KL105 405

Double-compartment cabinet
3 x CARGO drawer
2 x full door
3 x adjustable shelf

Dimensions (mm)*		
W	D	H
800x600x2100mm		
900x600x2100mm		
1000x600x2100mm		

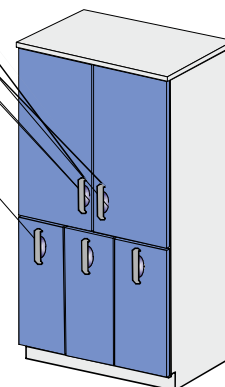

WORKTABLE

REF: KL101 101

Base frame equipped with feet that can be levelled.
Worktop made of stainless-steel grade OH18N9,
with noise-damping insulation, with back protection

Dimensions (mm)*		
W	D	H
600x600x900mm		
800x600x900mm		
900x600x900mm		

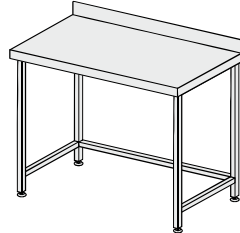

WORKTABLE

REF: KL101 111

Base frame equipped with feet that can be levelled.
Worktop made of stainless-steel grade OH18N9,
with noise-damping insulation, with back protection

Dimensions (mm)*		
W	D	H
1400x600x900mm		
1600x600x900mm		
1800x600x900mm		

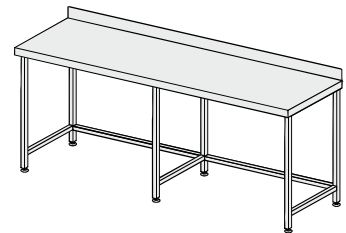

WORKTABLE

REF: KL100 014

Base frame equipped with feet that can be levelled.
Worktop & shelf made of stainless-steel grade
OH18N9, worktop with noise-damping insulation,
with back protection

Dimensions (mm)*		
W	D	H
1400x600x900mm		
1500x600x900mm		
1600x600x900mm		

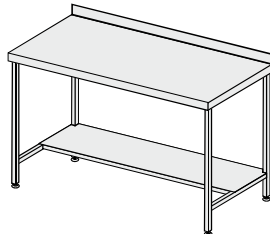

WORKTABLE

REF: KL100 002

Base frame equipped with feet that can be levelled.
Worktop & shelf made of stainless-steel grade
OH18N9, worktop with noise-damping insulation

Dimensions (mm)*		
W	D	H
1400x700x900mm		
1600x700x900mm		
1800x700x900mm		

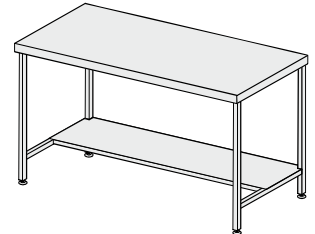

DRAINAGE WORKTABLE

REF: KL101 104

Base frame equipped with feet that can be levelled.
Drainage worktop made of stainless-steel OH18N9,
worktop with noise-damping insulation, with back
protection

Dimensions (mm)*		
W	D	H
600x600x900mm		
800x600x900mm		
900x600x900mm		

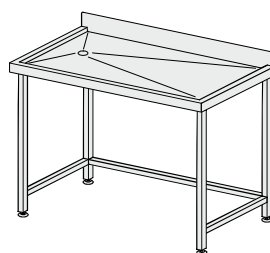

DRAINAGE WORKTABLE

REF: KL101 113

Base frame equipped with feet that can be levelled.
Drainage made of stainless-steel grade OH18N9,
worktop with noise-damping insulation, with back
protection

Dimensions (mm)*		
W	D	H
1400x600x900mm		
1600x600x900mm		
1800x600x900mm		

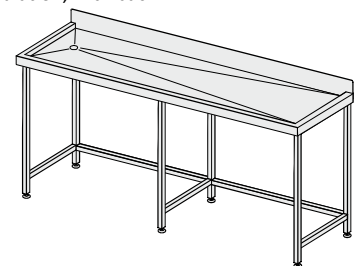

WORKSTATION

REF: KL101 102

Single-compartment open type cabinet.
Worktop made of stainless-steel grade
OH18N9, with noise-damping insulation,
with back protection.

Dimensions (mm)*		
W	D	H
800x600x900mm		
1000x600x900mm		
1200x600x900mm		

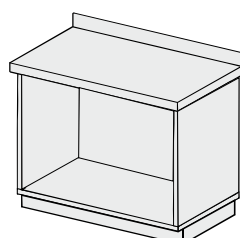

WORKSTATION

REF: KL101 112

Double-compartment open type cabinet.
Worktop made of stainless-steel grade
OH18N9, with noise-damping insulation,
with back protection.

Dimensions (mm)*		
W	D	H
1400x600x900mm		
1600x600x900mm		
1800x600x900mm		

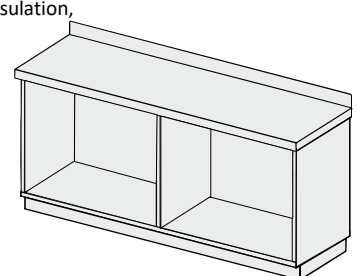

WORKTABLE

REF: KL100 001

Base frame equipped with feet that can be levelled.
Worktop made of stainless-steel grade OH18N9,
with noise-damping insulation

Dimensions (mm)*		
W	D	H
1400x700x900mm		
1600x700x900mm		
1800x700x900mm		

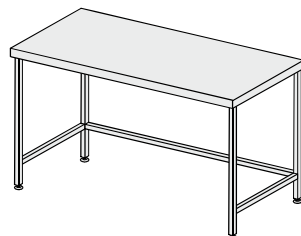

WORKSTATION

REF: KL101 103

Single-compartment open type cabinet, with
shelf. Worktop made of stainless-steel grade
OH18N9, with noise-damping insulation,
with back protection

Dimensions (mm)*		
W	D	H
600x600x900mm		
800x600x900mm		
900x600x900mm		

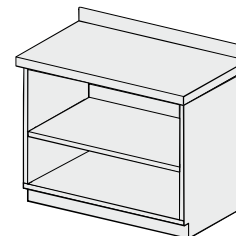

WORKTABLE

REF: KL101 201

Single-compartment cabinet with shelf.
Base frame equipped with feet that can be
levelled. Worktop made of stainless-steel
grade OH18N9, with noise-damping insulation,
with back protection

Dimensions (mm)*		
W	D	H
800x600x900mm		
1000x600x900mm		
1200x600x900mm		

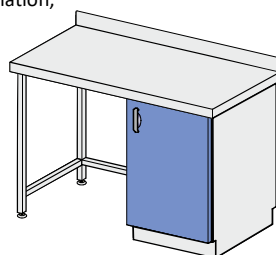

WORKSTATION

REF: KL101 211

Single-compartment cabinet with shelf &
open. Base frame equipped with feet that can
be levelled. Worktop made of stainless-steel
grade OH18N9, with noise-damping insulation

Dimensions (mm)*		
W	D	H
800x600x900mm		
1000x600x900mm		
1200x600x900mm		

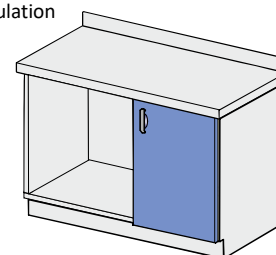

WORKTABLE

REF: KL101 202

Single-compartment cabinet with shelf & drawer.
Base frame equipped with feet that can be
levelled. Worktop made of stainless-steel
grade OH18N9, with noise-damping insulation,
with back protection

Dimensions (mm)*		
W	D	H
800x600x900mm		
1000x600x900mm		
1200x600x900mm		

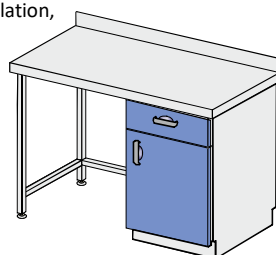

WORKSTATION

REF: KL101 212

Single-compartment cabinet with shelf and
drawer & open compartment. Base frame
equipped with feet that can be levelled.
Worktop made of stainless-steel grade
OH18N9, with noise-damping insulation

Dimensions (mm)*		
W	D	H
800x600x900mm		
1000x600x900mm		
1200x600x900mm		

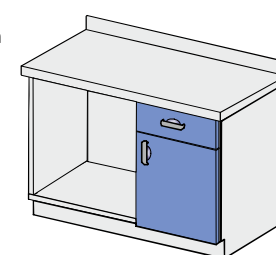

WORKTABLE

REF: KL101 203

Single-compartment cabinet with 3 drawers, width 400mm. Base frame equipped with feet that can be levelled. Worktop made of stainless-steel grade OH18N9, with noise-damping insulation, with back protection

Dimensions (mm)*		
W	D	H
800x600x900mm		
1000x600x900mm		
1200x600x900mm		

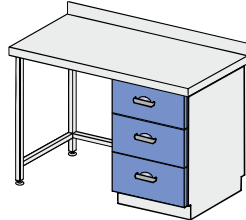

WORKSTATION

REF: KL101 213

Cabinet with 3 drawers, width 400mm & open compartment. Base frame equipped with feet that can be levelled. Worktop made of stainless-steel grade OH18N9, with noise-damping insulation, with back protection

Dimensions (mm)*		
W	D	H
800x600x900mm		
1000x600x900mm		
1200x600x900mm		

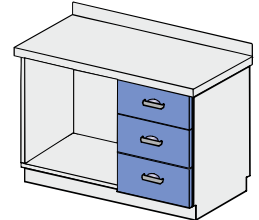

WORKTABLE

REF: KL101 204

Single-compartment cabinet with 4 drawers, width 400mm. Base frame equipped with feet that can be levelled. Worktop made of stainless-steel grade OH18N9, with noise-damping insulation, with back protection

Dimensions (mm)*		
W	D	H
800x600x900mm		
1000x600x900mm		
1200x600x900mm		

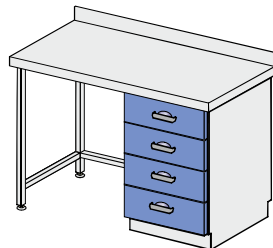

WORKSTATION

REF: KL101 214

Cabinet with 4 drawers, width 400mm & open compartment. Worktop made of stainless-steel grade OH18N9, with noise-damping insulation, with back protection

Dimensions (mm)*		
W	D	H
800x600x900mm		
1000x600x900mm		
1200x600x900mm		

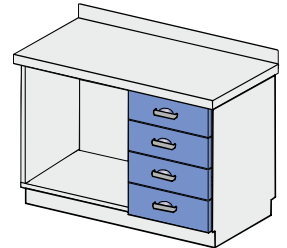

WORKTABLE

REF: KL101 301

Double-door cabinet with shelf, width 800mm. Base frame equipped with feet that can be levelled. Worktop made of stainless-steel grade OH18N9, with noise-damping insulation, with back protection

Dimensions (mm)*		
W	D	H
1200x600x900mm		
1400x600x900mm		
1600x600x900mm		

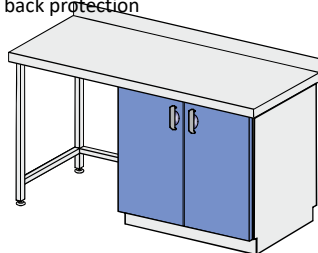

WORKSTATION

REF: KL101 311

Double-door cabinet with shelf, width 800mm & open compartment. Worktop made of stainless-steel grade OH18N9, with noise-damping insulation, with back protection

Dimensions (mm)*		
W	D	H
1200x600x900mm		
1400x600x900mm		
1600x600x900mm		

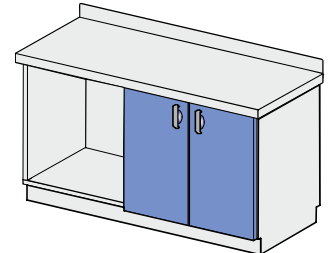

WORKING TABLE

REF: KL101 302

Single-door cabinet with shelf & 3 drawers, total width 800mm. Base frame equipped with feet that can be levelled. Worktop made of stainless-steel grade OH18N9, with noise-damping insulation, with back protection

Dimensions (mm)*		
W	D	H
1200x600x900mm		
1400x600x900mm		
1600x600x900mm		

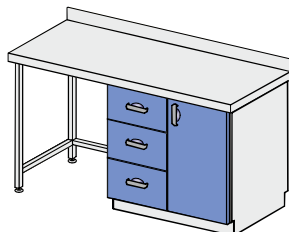

WORKSTATION

REF: KL101 312

Single-door cabinet with shelf & 3 drawers, total width 800mm & open compartment. Worktop made of stainless-steel grade OH18N9, with noise-damping insulation, with back protection

Dimensions (mm)*		
W	D	H
1200x600x900mm		
1400x600x900mm		
1600x600x900mm		

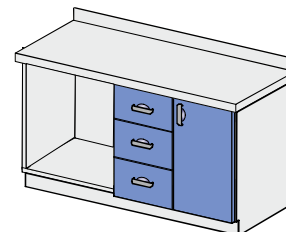

WORKTABLE with a lit tabletop

REF: KL100 010

Worktable with TRESPA type, lit table top. In standard: white safety glass, two electrical sockets, light diffusing plate. Base frame equipped with feet that can be levelled.

Dimensions (mm)*		
W	D	H
1400x700x900mm		
1600x700x900mm		
1800x900x900mm		

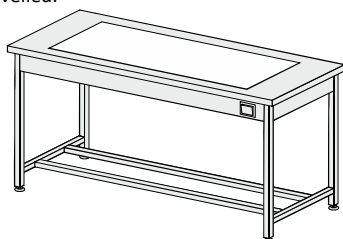

WORKTABLE with a lit tabletop

REF: KL100 011

Worktable with TRESPA type, lit table top. In standard: white safety glass, two electrical sockets, light diffusing plate. Base frame equipped with a shelf, placed on the leveling plinth.

Dimensions (mm)*		
W	D	H
1400x700x900mm		
1600x700x900mm		
1800x900x900mm		

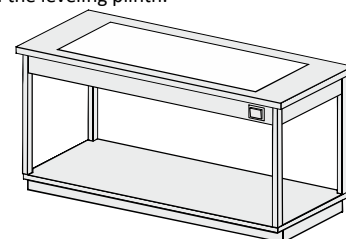

PLASTER PREPARATION WORKSTATION

REF: KL102 001

Base frame equipped with feet that can be levelled. Worktop with a sink, made of stainless-steel grade OH18N9, recessed with noise-damping insulation, with back protection

Dimensions (mm)*		
W	D	H
1200x600x900mm		
1400x600x900mm		
1600x600x900mm		

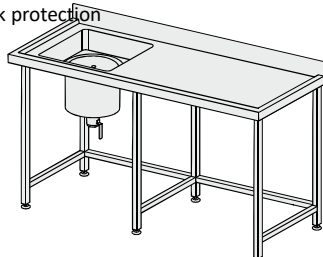

PLASTER PREPARATION WORKSTATION

REF: KAT. KL102 011

Cabinet with open compartment, width 700mm. Base frame equipped with feet that can be levelled. Worktop with a sink, made of stainless-steel grade OH18N9, recessed with noise-damping insulation, with back protection

Dimensions (mm)*		
W	D	H
1200x600x900mm		
1400x600x900mm		
1600x600x900mm		

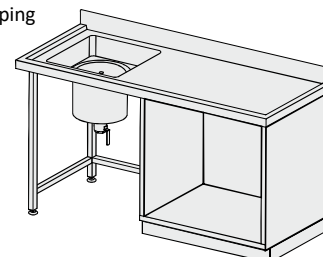

PLASTER PREPARATION WORKSTATION

REF: KL102 002

Double-door cabinet with shelf, width 800mm.
Base frame equipped with feet that can be levelled.
Worktop with a sink, made of stainless-steel grade OH18N9, recessed with noise-damping insulation, with back protection

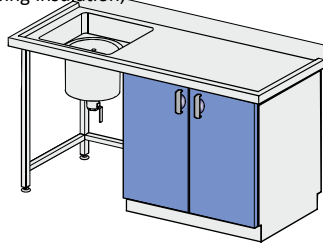

Dimensions (mm)*		
W	D	H
1400	600	900
1600	600	900

PLASTER PREPARATION WORKSTATION

REF: KL102 003

Single-door cabinet with shelf & 3 drawers, width 800mm. Base frame equipped with feet that can be levelled. Worktop with a sink, made of stainless-steel grade OH18N9, recessed with noise-damping insulation, with back protection

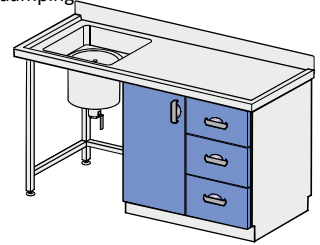

Dimensions (mm)*		
W	D	H
1400	600	900
1600	600	900

SINK WORKSTATION

REF: KL103 000

Single-door cabinet. Worktop with a sink, made of stainless-steel grade OH18N9, recessed with noise-damping insulation, with back protection

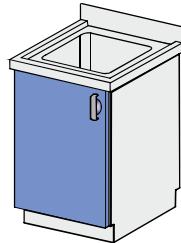

Dimensions (mm)*		
W	D	H
500	600	900
600	600	900

SINK WORKSTATION

REF: KL103 012

Base frame equipped with feet that can be levelled. Worktop with a sink, made of stainless-steel grade OH18N9, recessed with noise-damping insulation, with back protection

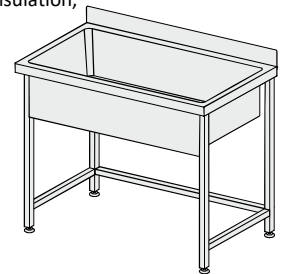

Dimensions (mm)*		
W	D	H
800	600	900
1000	600	900
1200	600	900

SINK WORKSTATION

REF: KL103 010

Base frame equipped with feet that can be levelled. Worktop with a single chamber sink, made of stainless-steel grade OH18N9, recessed with noise-damping insulation, with back protection

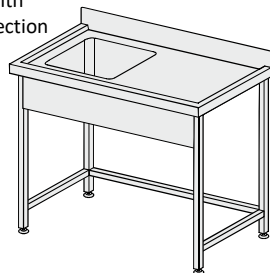

Dimensions (mm)*		
W	D	H
800	600	900
900	600	900
1000	600	900

SINK WORKSTATION

REF: KL103 018

Cabinet with open compartment. Worktop with a single chamber sink, made of stainless-steel grade OH18N9, recessed with noise-damping insulation, with back protection

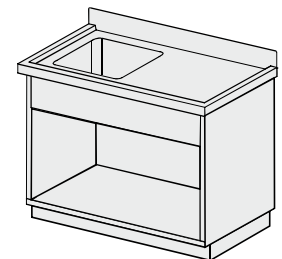

Dimensions (mm)*		
W	D	H
600	600	900
800	600	900
900	600	900



SINK WORKSTATION

REF: KL103 013

Single-door cabinet with shelf, width 400mm. Base frame equipped with feet that can be levelled. Worktop with a single-chamber sink, made of stainless-steel grade OH18N9, recessed with noise-damping insulation, with back protection

Dimensions (mm)*		
W	D	H
900x600x900mm		
1000x600x900mm		
1200x600x900mm		

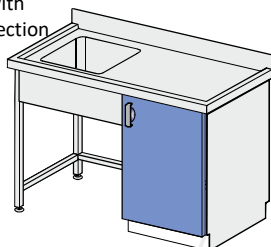

SINK WORKSTATION

REF: KL103 014

Single-door cabinet with shelf & drawer, width 400mm. Base frame equipped with feet that can be levelled. Worktop with a single-chamber sink, made of stainless-steel grade OH18N9, recessed with noise-damping insulation, with back protection

Dimensions (mm)*		
W	D	H
900x600x900mm		
1000x600x900mm		
1200x600x900mm		

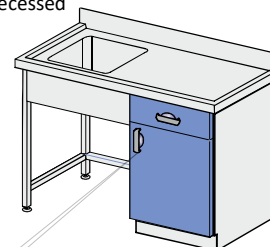

SINK WORKSTATION

REF: KL103 015

Cabinet with 3 drawers, width 400mm. Base frame equipped with feet that can be levelled. Worktop with a single-chamber sink, made of stainless-steel grade OH18N9, recessed with noise-damping insulation, with back protection

Dimensions (mm)*		
W	D	H
900x600x900mm		
1000x600x900mm		
1200x600x900mm		

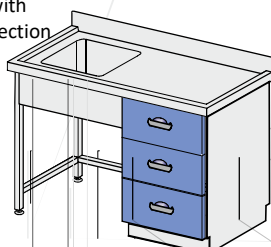

SINK WORKSTATION

REF: KL103 011

Base frame equipped with feet that can be levelled. Worktop with a double-chamber sink, made of stainless-steel grade OH18N9, recessed with noise-damping insulation, with back protection

Dimensions (mm)*		
W	D	H
900x600x900mm		
1000x600x900mm		
1200x600x900mm		

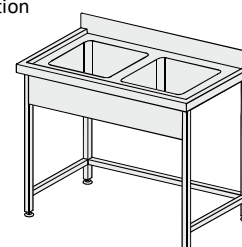

SINK WORKSTATION

REF: KL103 003

Sliding-doors cabinet. Worktop with a single-chamber sink, made of stainless-steel grade OH18N9, recessed with noise-damping insulation, with back protection

Dimensions (mm)*		
W	D	H
900x600x900mm		
1000x600x900mm		
1200x600x900mm		

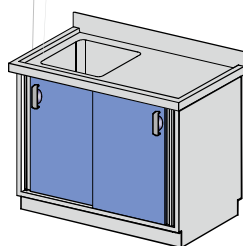

SINK WORKSTATION

REF: KL103 001

Double-door cabinet. Worktop with a single-chamber sink, made of stainless-steel grade OH18N9, recessed with noise-damping insulation, with back protection

Dimensions (mm)*		
W	D	H
800x600x900mm		
900x600x900mm		
1000x600x900mm		

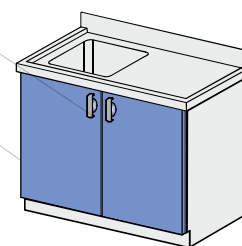

SINK WORKSTATION

REF: KL103 002

Double-door cabinet. Worktop with a double-chamber sink, made of stainless-steel grade OH18N9, recessed with noise-damping insulation, with back protection

Dimensions (mm)*		
W	D	H
800x600x900mm		
900x600x900mm		
1000x600x900mm		

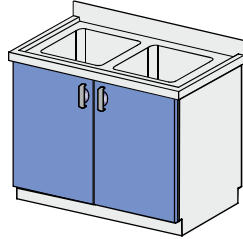

SINK WORKSTATION

REF: KL103 004

Sliding-doors cabinet. Worktop with a double-chamber sink, made of stainless-steel grade OH18N9, recessed with noise-damping insulation, with back protection.

Dimensions (mm)*		
W	D	H
800x600x900mm		
900x600x900mm		
1000x600x900mm		

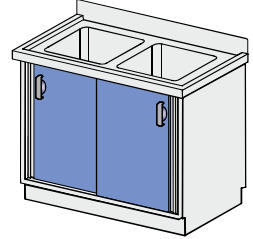

SINK WORKSTATION

EF: KL103 016

Double-door cabinet with shelf, width 800mm. Base frame equipped with feet that can be levelled. Worktop with a single-chamber sink, made of stainless-steel grade OH18N9, recessed with noise-damping insulation, with back protection

Dimensions (mm)*		
W	D	H
1400x600x900mm		
1600x600x900mm		

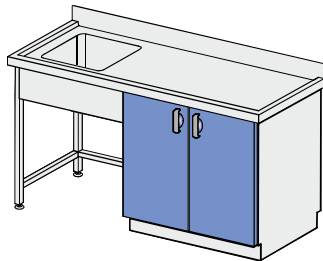

SINK WORKSTATION

REF: KL103 019

Double-door cabinet width 800mm with shelf & open compartment. Worktop with a single-chamber sink, made of stainless-steel grade OH18N9, recessed with noise-damping insulation, with back protection

Dimensions (mm)*		
W	D	H
1400x600x900mm		
1600x600x900mm		

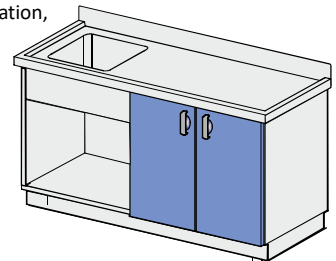

SINK WORKSTATION

REF: KL103 017

Single-door cabinet with shelf & 3 drawers, width 800mm. Base frame equipped with feet that can be levelled. Worktop with a single-chamber sink, made of stainless-steel grade OH18N9, recessed with noise-damping insulation, with back protection.

Dimensions (mm)*		
W	D	H
1400x600x900mm		
1600x600x900mm		

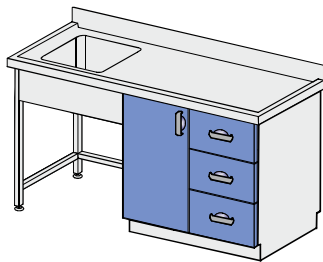

SINK WORKSTATION

REF: KL103 020

Single-door cabinet with shelf & 3 drawers, width 800mm, open compartment. Worktop with a single-chamber sink, made of stainless-steel grade OH18N9, recessed with noise-damping insulation, with back protection

Dimensions (mm)*		
W	D	H
1400x600x900mm		
1600x600x900mm		

